

switchee

Better Lives
With Intelligent Homes

Welcome to
your new Switchee
Your Smart Thermostat System



Switchee User Guide

What is switchee ?

The smart thermostat...

Switchee is a smart, internet-connected thermostat for your Heating / Hot Water that doesn't require WIFI.

Better manage your hot water/heating...

Switchee is a simple, easy-to-use device that gives you greater control – so you can set your heating/hot water to suit your individual needs.

Save money and reduce your carbon footprint...

Switchee helps you optimise energy use, lowering bills and reducing energy consumption– making it good for you and the environment!

The Switchee



The Thermostat Display

The touch-screen display on your Switchee is made up of a **central temperature display** surrounded by a number of 'tool' buttons. The functions of these buttons are shown on the page opposite.

Standby Mode

On **Standby**, your Switchee displays your target and **room temperature** in your home in white text on a black background.

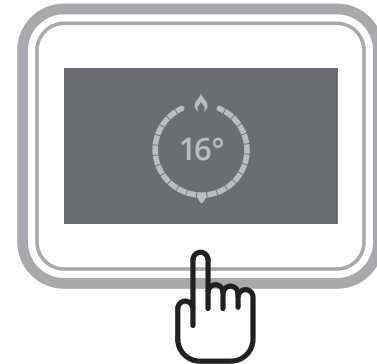

Display Button Functions



Settings

Tap to access the settings menu.



Central Temperature Display

Shows the room and target temperatures.



Messages

Tap to access the messages sent to your Switchee.

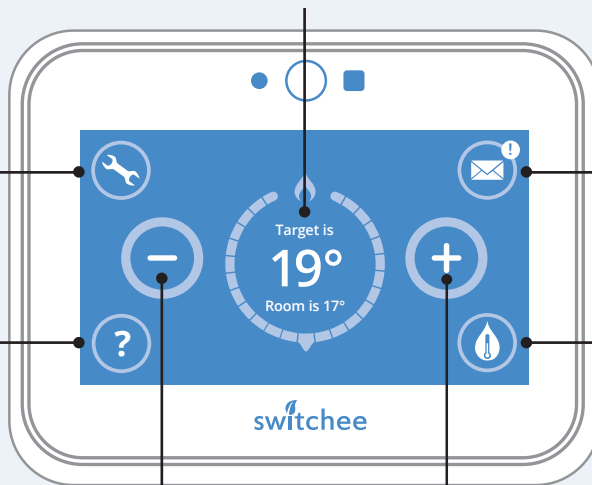

Help Menu

Tap to access the different ways to contact our resident support if you have any questions or need some help.



Decrease temperature



Increase temperature



Hot Water

Tap to turn your Hot Water ON/OFF (if your Switchee controls your Hot Water).

The Switchee Receiver Unit

The **Switchee Receiver Unit** passes on Heating/Hot Water commands from the **Switchee** to your boiler. It is connected to your boiler and is usually located near your boiler or Hot Water tank.

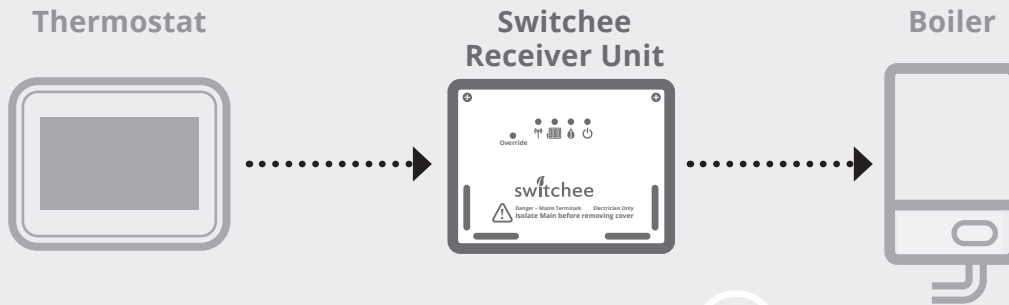

Switchee Receiver Unit there are four icons with lights above them...



Wireless

If your **Switchee** is installed wirelessly there will be a solid green light when connected.

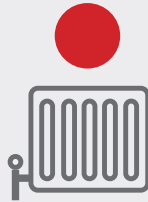

Heating

When you increase the target **temperature** above the room temperature the red light will come ON. It will turn OFF when the **target temperature** is reached and/or the Heating is turned OFF.



Hot Water

If your **Switchee** controls your **Hot Water**, the red light will come on when the **Hot Water** is turned ON.



Power

When power to the **Switchee Receiver Unit** is ON, a solid green light will be displayed above the icon.

Override Button

- To turn **ON** the Hot Water, press the **red** override button once. The LED above the Hot Water icon pulses between **red** and **orange**. (This won't work if your Switchee doesn't control your Hot Water/ if you have a combi-boiler).
- To turn **ON** the Heating, press the **red** override button a second time. The LED above the radiator icon pulses between **red** and **orange**.
- To turn both Heating and Hot Water **ON**, press the **red** override button for a third time. The LED above the radiator and Hot Water icons pulses between **red** and **orange**.
- To turn **OFF** the Heating and Hot Water, push the **red** override button for a fourth time. The LED above the radiator or Hot Water icons will go off. The Heating and Hot Water will then be **OFF**.

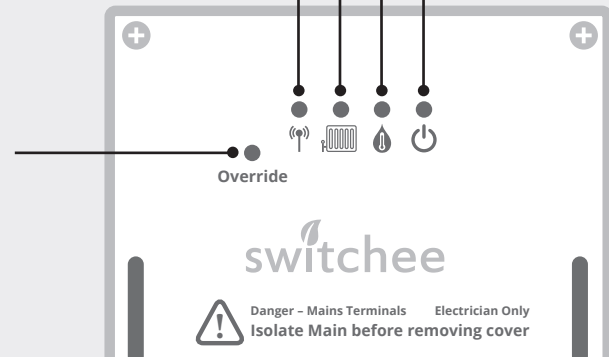

switchee

Better Lives
With Intelligent Homes



 www.switchee.co.uk/residents

 support@switchee.co.uk

 Somerset House, Strand, London WC2R 1LA

 0800 133 7957



ico.org.uk/yourdatamatters